



AirChek 20 Sample Pump

Cat. Nos. 920-2000 / 920-2002

Quick Guide

This Quick Guide covers basic operation of the SKC AirChek 20 Sample Pump. For complete pump operating instructions, visit the Knowledge Center at www.skcin.com



Figure 1. AirChek 20 Pump Overview

Installing and Charging the Battery

Install. The AirChek 20 pump (Figure 1) is supplied without battery Cat. No. P920201 installed. Install the battery as follows:

1. Unfasten the six casing screws (three on each side of the case, see Figure 1) using supplied Pozidriv size PZ1 screwdriver. Lift off black casing cover.
2. Remove the two protective covers from the battery terminals and place battery in rear compartment of pump case as shown in Figure 2. Ensure that equal gaps are left between ends of battery and sides of case to allow for case screws to be screwed in fully without damaging battery.
3. Connect red battery cable from pump control PCB to red '+' terminal on battery, and black battery cable to black '-' terminal on battery.
4. Reinstall black casing cover, securing it with the six screws using Pozidriv size PZ1 screwdriver.

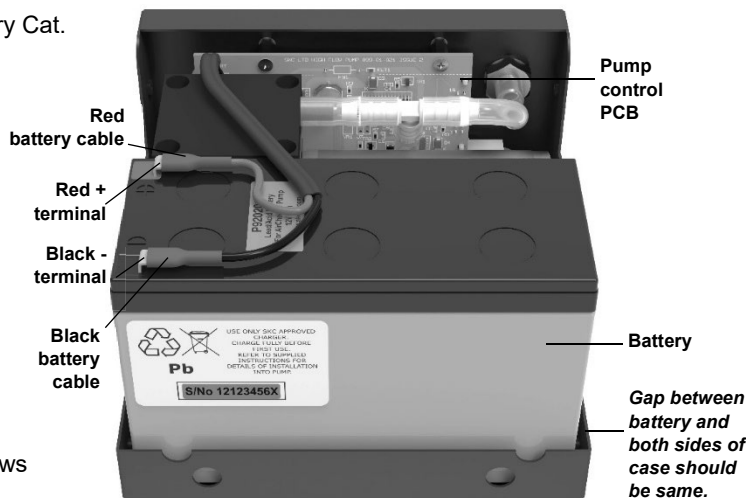

Figure 2. Installing the Battery

Charge. Before first use, the battery should be fully charged, ideally overnight.

AirChek 20 must only be charged using SKC Battery Charger Cat. No. 920-210.

- The battery charger can only be used to charge the battery when the pump is **not** running, and not when the pump is running to extend pump run time.
 - AirChek 20 can be powered by AC Adapter Cat. No. 920-211 suitable for 100-240 V or by an external high capacity 12V lead-acid battery (not SKC supplied) using external Battery Cable Cat. No. 920-212. It is recommended that these options be used in conjunction with internal battery Cat. No. P920201 to retain the pump program and run time data when external power supplies are disconnected.
1. Unscrew dust cap from charging/power socket on pump (see Figure 1) and connect output connector from charger to pump socket. Screw charging connector into socket to prevent it from detaching while charging.
 2. Plug charger into a 100 to 240 V wall outlet. LED indicator on charger will illuminate amber to indicate that charger is charging at full power.

3. Leave pump to charge fully. A fully depleted battery will take approximately 10 hours to charge. When battery is fully charged, LED indicator on charger will illuminate green to indicate that charger has switched to trickle charge, thus preventing overcharging.
4. When pump is fully charged (see LCD screen display at right), unplug charger from wall outlet and disconnect charger output connector from pump. **Note:** Always attach screw-in dust cap to charging/power socket on pump after charging.

Powering On/Waking Pump

When the pump battery is charged, press the keys on the pump keypad (see Figure 1 and Using Pump Keypad and LCD) in the sequence **Enter, Select, Enter**. The pump will display the SELECT main menu screen.

When not using the pump, place it in sleep mode to conserve battery power. In SELECT main menu screen, scroll to Sleep and press the Enter key.

Using the Pump Keypad and LCD (see Figure 1)

Press to scroll through menu options and select digits to adjust when entering times.

Press to accept the selected menu option or run time.

Press to enter sample run times and set pump flow rate.

Press keys in sequence: **Enter, Select, Enter** to display SELECT main menu screen.

Setting/Verifying Flow Rate

1. Power on pump and prepare flowmeter per flowmeter instructions.
2. Set up flow rate verification train with representative sample medium in line. **Note:** When using SKC High Flow checkmate Flowmeter, Pulsation Dampener Cat. No. 375-150 is required in line between sample media inlet and flowmeter outlet.
3. In SELECT main menu screen, scroll to Setup and press Enter key to display Setup menu.
4. In Setup menu, scroll to Flow and press the Enter key. Pump will start to run.

SET FLOW screen will be displayed.

5. Press up and down arrow keys to increase and decrease pump flow rate (arrows displayed on LCD will indicate increased or decreased flow rate). **Note:** Pressing and holding up and down arrow keys increments or decrements flow rate rapidly. When maximum or minimum possible flow rate is reached, LCD will display series of arrows and "Max" or "Min" accordingly.

6. While observing reading on flowmeter, use up and down arrow keys to set required flow rate. When pump is running at required flow rate, press Enter key to save flow rate setting and return to SELECT main menu screen.

Sampling

Manual Run. In SELECT main menu, scroll to Run and press Enter key. Pump will run and elapsed run time will be displayed counting up in hours, minutes, and seconds. At end of required sampling time, simultaneously press Select and Enter keys to access Hold menu screen; scroll to Reset and select it by pressing Enter key.

Programmed Runs. For timed runs, delayed starts, and intermittent sampling, see complete operating instructions in the Knowledge Center at www.skccinc.com.

Registering the Pump: Registering your AirChek 20 Pump is as easy as going to the SKC website and provides the added benefits of the latest product information and free technical support. **Go to skccinc.com/warranty.**

Free Technical Support: Rely on SKC Tech Support for the answers you need at skctech@skccinc.com.